

# Line regulator LM52<sup>exact</sup>-6

spectro lab



Line regulator  
LM52<sup>exact</sup>-6

## Specifications

- SPECTROLAB-components guarantee maximum quality by using high grade materials and a quality assurance program acc. to ISO 9001.
- All parts in the gas wetted surface area are cleaned in an ultrasonic cleaning system (CFC-free) with the special Cleaning process SPECTRO-CLEAN® and then baked out.
- SPECTROLAB-components undergo a 100% function- and Helium-leak-test.

## Product features

- Brass (chrome plated) line pressure regulator
- Extremely stable outlet pressure by applied extremely accurate Technology "exact" and anti- vibration device
- For non-corrosive gases and gas mixtures up to quality 6.0
- 6 ports for flexible and individual configuration
- Suitable for inlet pressures up to 300 bar
- Max. outlet pressures 1.5 up to 20 bar
- Light weight
- Compact design
- Metal-to-metal seal to atmosphere
- Suitable for ECD-applications
- Pressure regulator can be evacuated
- Central filter
- Approved for use with oxygen
- Simple outlet pressure limitation by handwheel
- Easy to install
- New laboratory-style design
- Ergonomically designed

**exact** = extremely accurate technology

## Technical data

<b>Type</b>	single-stage EXACT
<b>Inlet pressure P<sub>1</sub></b>	max. 300 bar
<b>Outlet pressure P<sub>2</sub></b>	1.5 / 4 / 10 / 20 bar
<b>Materials</b>	
Body regulator, relief valve:	chrome plated brass
Valve seat:	PA
Diaphragm:	Hastelloy C276
Soft goods:	EPDM
Filter:	Sintered SS 316L
<b>In- and outlets</b>	1/4" NPT female
<b>Temperature range</b>	-30°C to +60°C
<b>Leak rate (to atmosphere)</b>	1x10 <sup>-8</sup> mbar l/s He
(via seat)	1x10 <sup>-6</sup> mbar l/s He
<b>Pressure gauge</b>	Safety pressure gauges ISO5171/KI1.6/NG50
<b>Flow capacity</b>	C <sub>v</sub> =0.16
<b>Weight</b>	1.1 kg

Dimensions  
LM52<sup>exact</sup>-6

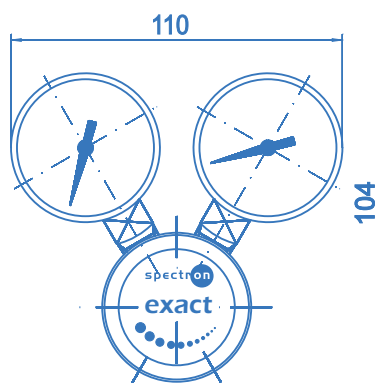

Side view

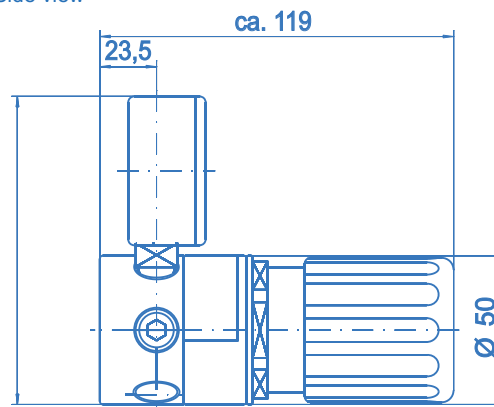

# Line regulator LM52<sup>exact</sup>-6

**spectron lab**

## Ordering information:

Line regulator LM52<sup>exact</sup>-6

### In- / outlets

CM 1/4	- 1/8" / 1/4" / 1/2"	- OD compression fitting (brass)
CM 6	- 3 / 6 / 8 / 10 / 12	mm compression fitting (brass)
CE 1/4	- 1/8" / 1/4" / 1/2"	- OD compression fitting (stainless steel)
CE 6	- 3 / 6 / 8 / 10 / 12	mm compression fitting (stainless steel)
B		- plug
A		- relief valve - 1/4"-NPT-F
K		- contact gauge
M		- pressure gauge
0		- 1/4"-NPT-F (port only)

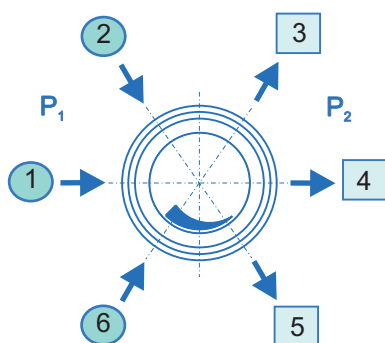

Inlet left: **L**

**LM52 - 6 - L - 300 - 20 - 1 - 2 - 3 - 4 - 5 - 6 - N2**

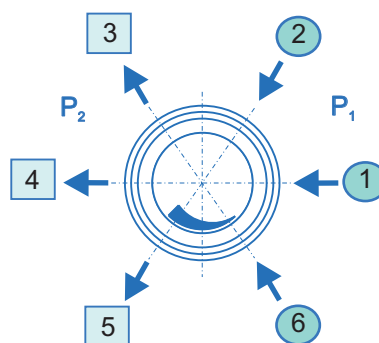

Inlet right: **R**

### Inlet

- L - left
- R - right

### Inlet pressure P<sub>1</sub>

- 100 - max. 100 bar
- 200 - max. 200 bar
- 300 - max. 300 bar

### Outlet pressure P<sub>2</sub>

- 1,5 - to 1.5 bar
- 4 - to 4 bar
- 10 - to 10 bar
- 20 - to 20 bar

### Type of gas

Please specify type of gas  
(for selection of valve seat materials)

For inlet pressure up to 50 bar and outlet pressure of max. 1,5 or 4 bar please use M51

## Ordering example:

**LM52-6-L-20-10-CE6-M-M-CE6-A-B-N2**

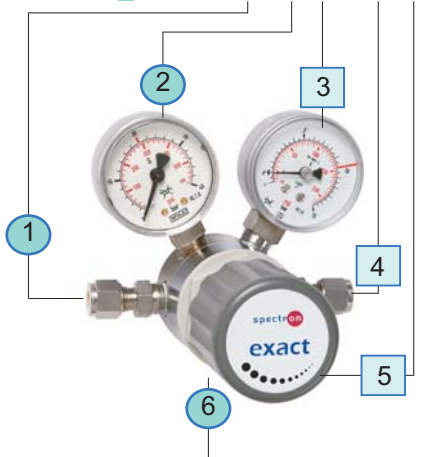

## Ordering example:

**LM52-6-R-200-10-0-M-M-CE1/8-A-B-Ar**

